

**KDC 47****KDC 67**

KDC STRAIGHT GLASS ICE CREAM DIPIPING CABINETS/ GELATO CASES

The KDC straight glass dipping cabinets are the most trusted and cost effective ice cream dipping cabinet design for over 90 years.

Global's upgrades and the patented Kelvinator refrigeration design deliver top performance, consistent temperature throughout the interior of the cabinet and the LED lighting brilliantly illuminate the ice cream products. Gelato Pan Rack kits are available allowing gelato to be served from this model.

The KDC dipping cabinets are available in (4) hole, (8) hole, (12) hole and (16) hole models.



All products are certified for energy , safety and sanitation. NSF/ ANSI 7 Standards

FEATURES

- 20 Gauge steel cabinet with white powder coat paint interior/exterior
- LED Lighting
- Stainless steel straight front glass canopy with stainless steel top
- Patented Kelvinator refrigeration design
- Digital temperature controller with LED display
- Interior Temperature +10°F to -15°F
- Plexi-glass lids with full length handles
- Independent on/off switch for compressor & lights
- Manual Defrost/ Drain hose
- Energy star

ACCESSORIES

- Can Skirt Kits
- Gelato Pan Rack Kits
- Frost Shield Kits
- Dipperwell Kit
- Night Cover Kits
- Caster Kit
- Leg Kit
- Stainless Steel Exterior

KDC Straight Glass Dipping Cabinets

TECHNICAL DATA

MODEL	KDC27	KDC47	KDC67	KDC87
Temp Range	+10°F to -15°F	+10°F to -15°F	+10°F to -15°F	+10°F to -15°F
Exterior Dimensions				
Length	25.75	46.5"	67"	88"
Depth	26.75	26.75"	26.75"	26.75"
Height	50.56	50.56"	50.56"	50.56"
Capacity				
Capacity (3-gal. tubs)	4	12	20	28
Facings (3-gal. tubs)	4	8	12	16
Storage (3-gal. tubs)	0	4	8	12
Compressor				
Compressor	Hermetic	Hermetic	Hermetic	Hermetic
Shipping Weight				
Shipping Weight	300 lbs.	465 lbs.	565 lbs.	745 lbs.
Condensor Type				
Condensor Type	Bare Tube	Bare Tube	Bare Tube	Bare Tube
Lighting				
Lighting	LED	LED	LED	LED
Electrical				
Electrical	NEMA 5-15P	NEMA 5-15P	NEMA 5-15P	NEMA 5-15P
Rated Amps				
Rated Amps	4.5	11.0	12.0	12.0

SPECIFICATIONS

KDC27,47,67,87

Global KDC Straight Glass Ice Cream Dipping Cabinets construction shall consist of 20 gauge white powder coat finished galvanized steel interior & exterior, foamed in place.

Cabinet as specified to use R404-A refrigerant. Refrigeration control shall be thermostatic control with a temperature range of +10°F to -15°F. Cabinet to have independent on/off switch for compressor and light switch to be mounted in the shell of the cabinet and to be furnished with a drain connection. Cabinet to be provided as a rear-air intake and front-air discharge. Cabinet to be UL, C-UL and NSF certified.

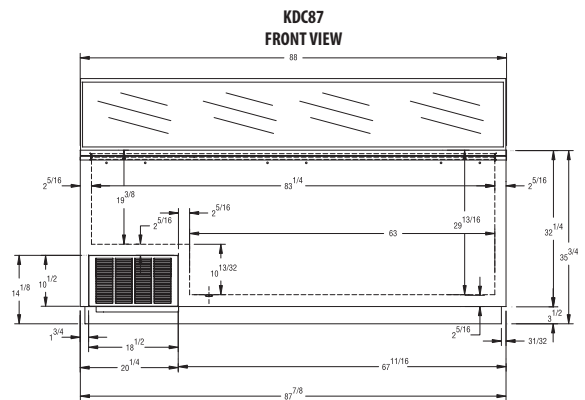
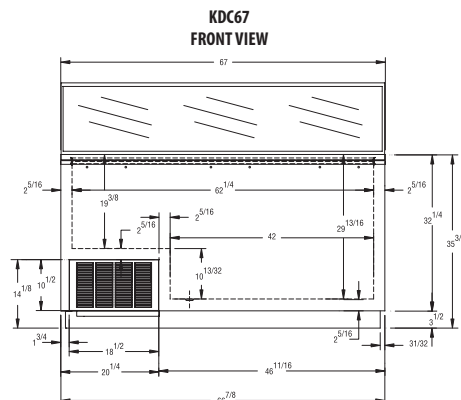
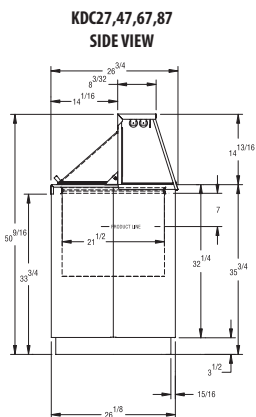
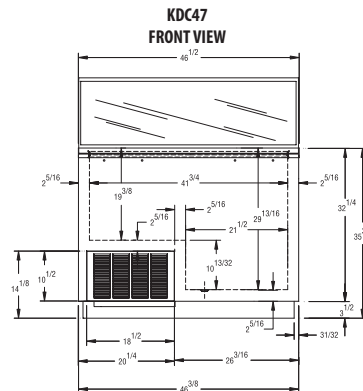
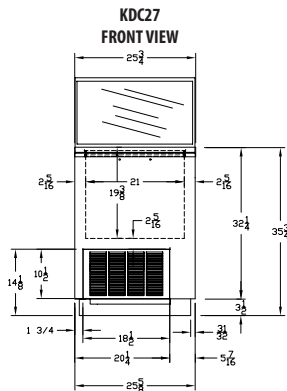
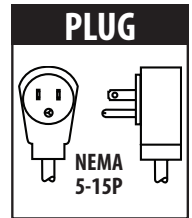

Cabinet designed for optimum performance in air-conditioned area at 70°F to 75°F ambient temperature and 50% to 55% relative humidity.

Global Refrigeration, Inc., reserves the right to change specifications, terms, and prices without notice.

Global Refrigeration, Inc.

5855 Grant Avenue, Cleveland, OH 44105

888.650.9799

www.globalref.com