



Profit from the Eagle Advantage®

# Specification Sheet

## Short Form Specifications

Eagle Chef's Line® Single-Tank Electric Fryer, model \_\_\_\_\_. Heavy gauge stainless steel top and front with aluminized steel sides. Stainless steel deep-drawn 10" x 14" fry tank is removable for cleaning or filtering. Snap action thermostat with indicator light, hi-limit safety control with reset button and indicator light. Two nickel-plated 4" x 11" fry baskets. Cast metal legs with flanged feet. 15-lb. fat capacity. Available in 120/60/1 15-amp, 208/60/1 19.8-amp, or 240/60/1 22.9-amp.

Eagle Chef's Line® Double-Tank Electric Fryer, model \_\_\_\_\_. Heavy gauge stainless steel top and front with aluminized steel sides. Stainless steel deep-drawn 10" x 14" fry tanks are removable for cleaning or filtering. Snap action thermostat with indicator light, hi-limit safety control with reset button and indicator light. Two nickel-plated 4" x 11" fry baskets per tank. Cast metal legs with flanged feet. 30-lb. fat capacity. Available in 208/60/1 39.6-amp or 240/60/1 45.8-amp.



single fryer

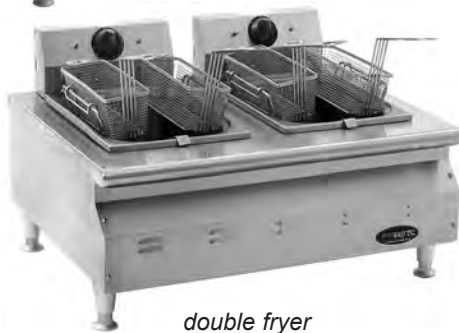

double fryer

### Options / Accessories

- Double fry basket
- Night cover

**NOTE: INTENDED FOR OTHER THAN HOUSEHOLD USE. THESE COMMERCIAL APPLIANCES MUST BE INSTALLED WITHIN SURROUNDINGS AND VENTILATION REQUIREMENTS AS DICTATED BY NATIONAL AND/OR LOCAL CODE.**

**EAGLE GROUP**  
 100 Industrial Boulevard, Clayton, DE 19938-8903 USA  
 Phone: 302-653-3000 • Fax: 302-653-2065  
 www.eaglegrp.com

**Foodservice Division: Phone 800-441-8440**  
**MHC/Retail Display Divisions: Phone 800-637-5100**

For custom configuration or fabrication needs, contact our **SpecFAB® Division**.  
 Phone: 302-653-3000 • Fax: 302-653-3091 • e-mail: specfab@eaglegrp.com

**Spec sheets available for viewing, printing or downloading from our online literature library at [www.eaglegrp.com](http://www.eaglegrp.com)**

*Eagle Foodservice Equipment, Eagle MHC, SpecFAB®, and Retail Display are divisions of Eagle Group. ©2012 by the Eagle Group*

Item No.: \_\_\_\_\_  
 Project No.: \_\_\_\_\_  
 S.I.S. No.: \_\_\_\_\_

## RedHots® Chef's Line® Fryers

### MODELS:

- |                                      |                                      |                                 |
|--------------------------------------|--------------------------------------|---------------------------------|
| <input type="checkbox"/> CLEF10-120  | <input type="checkbox"/> CLEF102-240 | <input type="checkbox"/> 309781 |
| <input type="checkbox"/> CLEF10-120M | <input type="checkbox"/> 307543      | <input type="checkbox"/> 361993 |
| <input type="checkbox"/> CLEF10-240  | <input type="checkbox"/> 307546      |                                 |

### Single-Tank Fryers

- 15-lb. fat capacity.
- Equipped with cord and plug for easy installation.
- Two nickel-plated fry baskets provided.

### Double-Tank Fryers

- 30-lb. fat capacity.
- Equipped with terminal block for field-wiring.
- Four nickel-plated fry baskets provided.

### Easy operation

- Fill with fat or shortening up to indicator line.
- Set thermostat dial for desired temperature. The amber light will stay on. When temperature is reached, the light will go out and cooking can start.
- After cooking, lift basket(s), hang and drain.

### Design and construction features on all units

- All-stainless steel fry tank is deep-drawn one-piece construction, removable for easy cleaning or filtering of fat.
- Stainless steel top and control panel.
- Snap action thermostat complete with indicator light for accurate temperature control.
- Temperature range: from 200°F to 375°F
- Hi-limit safety control provides total system shutdown in case of malfunction. Complete with reset button and indicator light.
- Heating elements are self-cleaning Incoloy® sheath for long life and high performance.
- Lift-up heater design with two-position stop for draining and removal of tank.
- 4" x 11" (102 x 279mm) fry baskets with heavy plated mesh construction. Optional double fry baskets available.
- Heavy duty cast metal legs with flanged feet adjustable from 4" to 5" (102 to 127mm).

### Warranty

- Backed by a 1-YEAR Parts & Labor Warranty.

### Certifications / Approvals



### AUTOQUOTES



EG35.19 Rev. 05/12



Profit from the Eagle Advantage®

Item No.: \_\_\_\_\_  
 Project No.: \_\_\_\_\_  
 S.I.S. No.: \_\_\_\_\_

## RedHots® Chef's Line® Fryers

### Single-Tank Fryers

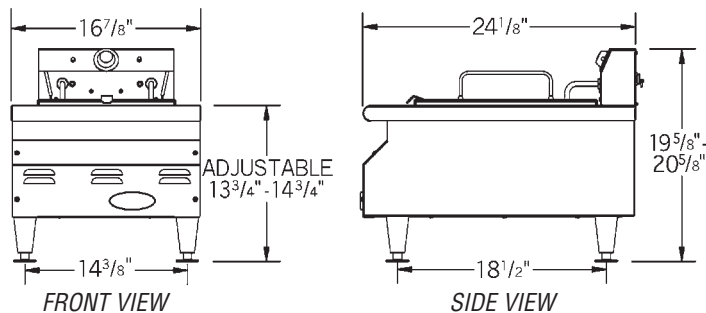

model #	electric data (based on single phase connection)	NEMA plug	performance* — french fries, raw-to-finish	width		length		weight	
				in.	mm	in.	mm	lbs.	kg
CLEF10-120	120V, 15A, 1800W	5-15	120V: 6 lbs. (2.7 kg)/hr	16 <sup>3</sup> / <sub>4</sub> "	426	24 <sup>1</sup> / <sub>8</sub> "	613	31	14.1
CLEF10-120M ■	120V, 15A, 1800W	5-20	120V: 6 lbs. (2.7 kg)/hr	16 <sup>3</sup> / <sub>4</sub> "	426	24 <sup>1</sup> / <sub>8</sub> "	613	31	14.1
CLEF10-240**	208/240V, 19.8/22.9A, 4125/5500W	6-30	208V: 20 lbs. (9.1 kg)/hr 240V: 30 lbs. (13.6 kg)/hr	16 <sup>3</sup> / <sub>4</sub> "	426	24 <sup>1</sup> / <sub>8</sub> "	613	31	14.1

\* Double the performance for pre-cooked convenience foods. Pre-heat to 350°F for 4½ minutes. Fryer performance is limited by the maximum available voltage in line.

\*\* 240-volt models can be used for 208V or 240V operation.

■ #CLEF10-120M features NEMA 5-20P plug, which meets Canadian requirements.

### Double-Tank Fryers

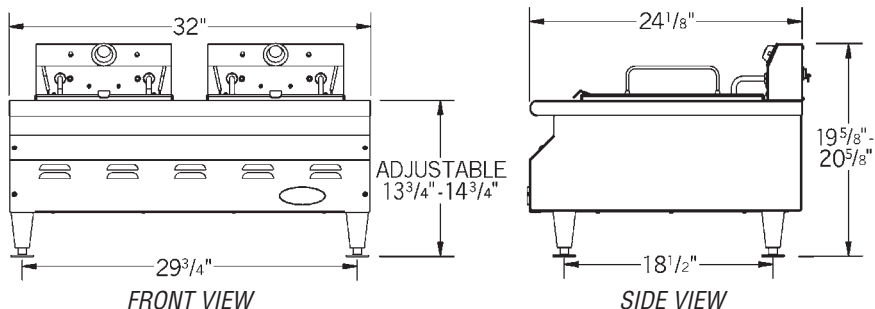

model #	electric data (based on single phase connection)	performance* — french fries, raw-to-finish	width		length		weight	
			in.	mm	in.	mm	lbs.	kg
CLEF102-240**	208/240V, 39.6/45.8A, 8250/11000W	208V: 40 lbs. (18.1 kg)/hr 240V: 60 lbs. (27.2 kg)/hr	32"	813	24 <sup>1</sup> / <sub>8</sub> "	613	61	27.7

\* Double the performance for pre-cooked convenience foods. Pre-heat to 350°F for 4½ minutes. Fryer performance is limited by the maximum available voltage in line.

\*\* 240-volt models can be used for 208V or 240V operation.

### Accessories/Replacements for Electric Fryers

model #	description
307543	replacement basket, left side, for single-tank fryers only
307546	replacement basket, right side, for single-tank fryers only
309781	double-fry basket, 8 <sup>3</sup> / <sub>4</sub> " x 9 <sup>1</sup> / <sub>4</sub> " x 4" (210 x 235 x 102mm)
361993	night cover*

\* For double-tank fryers, two night covers are required.

**EAGLE GROUP**  
 100 Industrial Boulevard, Clayton, DE 19938-8903 USA  
 Phone: 302-653-3000 • Fax: 302-653-2065  
 www.eaglegrp.com

Foodservice Division: Phone 800-441-8440  
 MHC/Retail Display Divisions: Phone 800-637-5100

Printed in U.S.A.  
 ©2012 by Eagle Group  
 Rev. 05/12

Spec sheets available for viewing, printing or downloading from our online literature library at [www.eaglegrp.com](http://www.eaglegrp.com)

Although every attempt has been made to ensure the accuracy of the information provided, we cannot be held responsible for typographical or printing errors. Information and specifications are subject to change without notice. Please confirm at time of order.