

MOGC90PM.INT

MOGCS45G.INT

MOGCS45D.INT

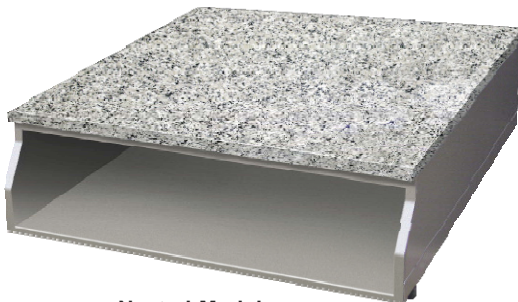

Neutral Module

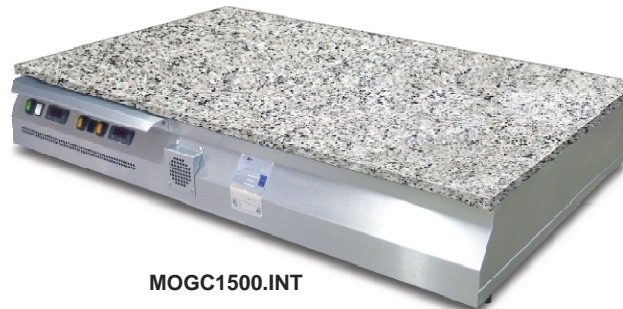

MOGC1500.INT

GRANITE-TOP MODULES

HEATED OR MULTI-USE

Rotisol is proud to offer a unique line of integrable heated or unheated granite countertop modules. Modules can be combined with existing cabinetry to create a dramatic presentation, keeping hot food attractive for hours. Twelve shapes and sizes allow a versatile array of layouts. The 8½" tall modules come with a plain front and sit on four adjustable feet for leveling. Optional enamel and stainless front panels are available in a variety of colors. Heated modules are controlled by electric thermostat.

For more information:

www.rotisolusa.com/commercial/displaymod

www.rotisolusa.com/downloads.shtml



HEATED GRANITE COUNTER TOP MODULES

ROTISOL is proud to offer a unique concept of fully open counter top modules with heated granite. This concept creates a dramatic presentation and the smooth and uniform heat all across the entire granite surface allowing to maintain hot food attractive for hours on.

With a height of only 8-1/2" (adjustable feet included) and no front, Rotisol Granite counter tops are ideal for use on any buffet lines. They come in a wide variety of sizes and angles with several granite colors. You can easily install them on any counters cabinets and behind any custom fronts to complement your display area.

STANDARD FEATURES :

- HEATED ELEMENTS uniformly spread under the granite surface
- ELECTRONIC TEMPERATURE SETTING of the granite with a thermostatic temperature probe inserted inside the granite. The digital control can be adjusted to hold the required temperature of the products
- TEMPERATURE range can be set to a maximum of 230 °F

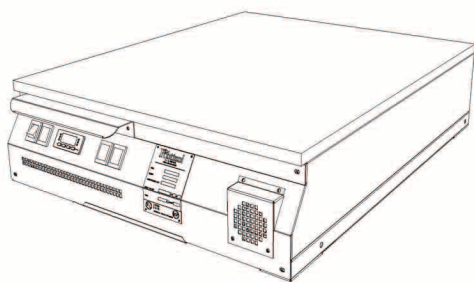

OPTIONAL FEATURES :

- CABINET, 26 1/4" height
- HEATED DRAWER (available only for 700/ 1100/ 1500 Model) with cabinets
- HEATED LAMPS

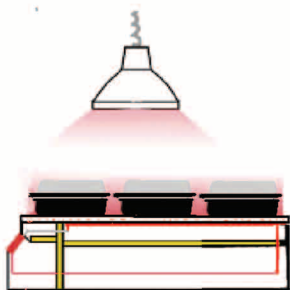

FINISH FEATURES :

COUNTER TOPS COLOR FINISH:

- All panels are in stainless steel

GRANITE COLOR:

- Std: GREY sarde granite
- Lx: BLACK absolute granite (please contact us for other color)

NOTE :

- * All the units are also available in NEUTRAL
- * Heat lamps required when using an open heated case
- * Please consult our design department for drawings and lay out

Ref. MOGC355INT

Ref. MOGC700INT

Ref. MOGC1100INT

Ref. MOGC1500INT

Ref. MOGC45GINT

Ref. MOGC45DINT

Ref. MOGC45GIINT

Ref. MOGC45DIINT

Ref. MOGC15GINT

Ref. MOGC15DINT

Ref. MOGC15GIINT

Ref. MOGC15DIINT



Rotisol - France, Inc.

341 North Oak St. - Inglewood - CA 90302 - USA
 Tel. : (310) 671-7254 - (800) 651-5969
 Fax. : (310) 671-8171 - (310) 671-8176
 www.rotisolusa.com - info@rotisolusa.com

SPECIFICATION HEATED GRANITE COUNTER TOP MODULES

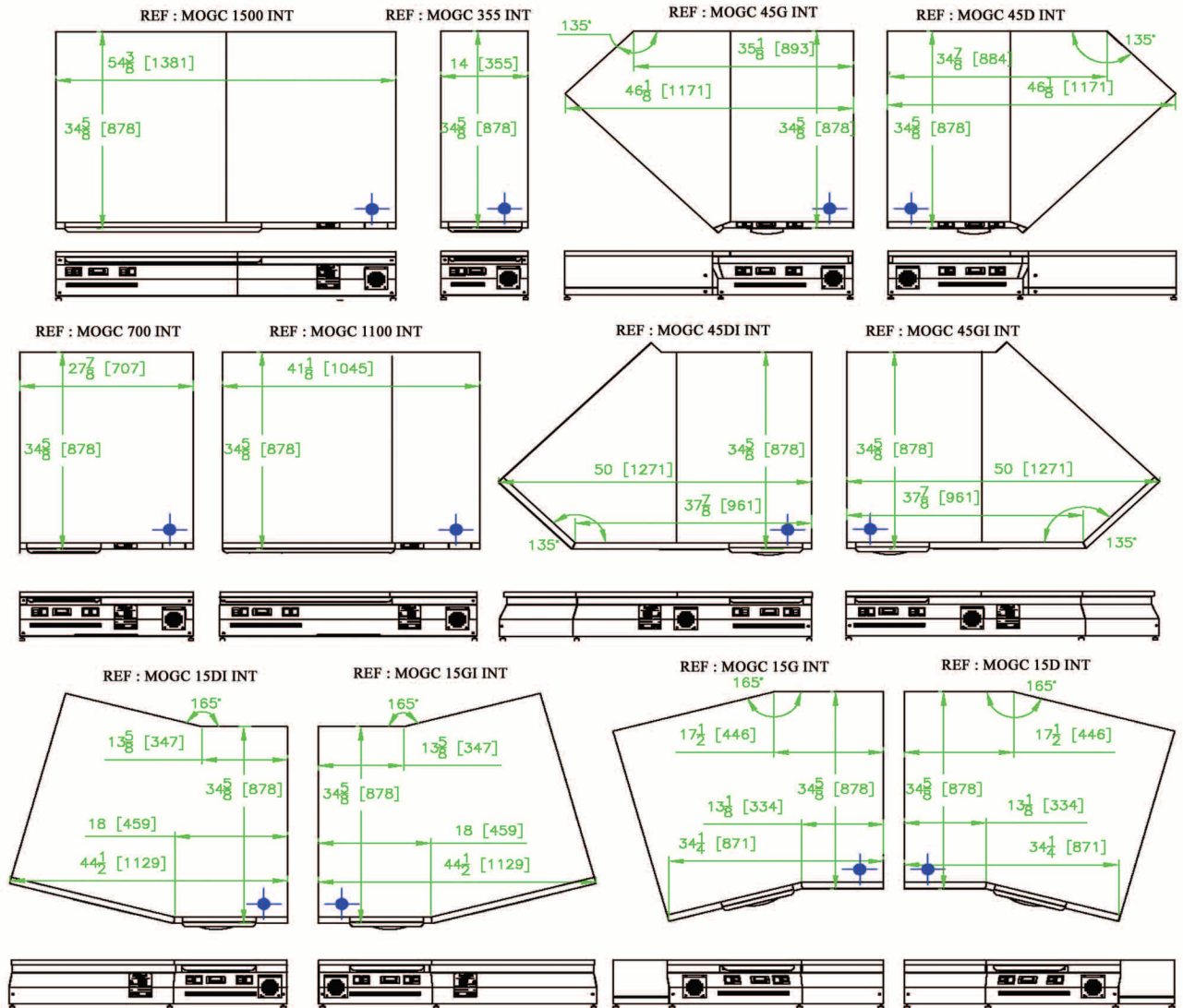

REF	Unit Dimension *						Electrical Spec				Heated	Independent
	W	D	H	W	D	H	Volt	Watts	Phases	Amps	Area	Heated Zone
1500	1381	878	197	54.4	34.6	7.8	208	4100	3	11.4	12.6 sq ft	2
1100	1046	878	197	41.2	34.6	7.8	208	3050	3	8.5	9.5 sq ft	1
700	708	878	197	27.9	34.6	7.8	208	2220	3	6.2	6.4 sq ft	1
355	355	878	197	14.0	34.6	7.8	208	750	3	2.1	3.2 sq ft	1
45D	1171	878	197	50.1	34.6	7.8	208	2220	3	6.2	8.6 sq ft	1
45G	1171	878	197	50.1	34.6	7.8	208	2220	3	6.2	8.6 sq ft	1
45DI	1271	878	197	50.1	34.6	7.8	208	2220	3	6.2	9.3 sq ft	1
45GI	1271	878	197	50.1	34.6	7.8	208	2220	3	6.2	9.3 sq ft	1
15D	1129	878	197	44.5	34.6	7.8	208	2220	3	6.2	9.5 sq ft	1
15G	1129	878	197	44.5	34.6	7.8	208	2220	3	6.2	9.5 sq ft	1
15DI	1129	878	197	44.5	34.6	7.8	208	2220	3	6.2	9.2 sq ft	1
15GI	1129	878	197	44.5	34.6	7.8	208	2220	3	6.2	9.2 sq ft	1

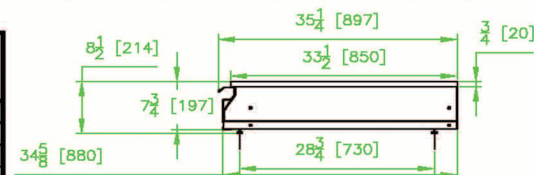

SIDE VIEW FOR
REF : MOGC INT

WARRANTY CONDITIONS:

Rotisol warrants its equipment to be free from defects in material and workmanship. The warranty covers parts for one year and labor for six months. Repairs must be performed by an authorized service company and it is the responsibility of the customer to return the defective parts to Rotisol France, Inc. within 15 days (otherwise, the warranty will not be honored). The shipping charges for replacement parts, other than ground, will be at the customer's expense. This warranty does not cover glass door breakage and quartz or halogen lamps breakage, neither does it cover the non-mechanical parts. This warranty does not apply to damages by accident, incorrect line voltage, fire, water, or other acts or God.