



Model: \_\_\_\_\_ Item #: \_\_\_\_\_ Date: \_\_\_\_\_

Project: \_\_\_\_\_ Qty: \_\_\_\_\_ Approved By: \_\_\_\_\_

## Hand Sinks w/ Electronic Faucets

## Hand Sinks

### HS-11

16" Wide Hand Sink with Electronic Faucet



### HS-12

16" Wide Hand Sink with Electronic Faucet, P-Trap & Overflow



### HS-13

16" Wide Hand Sink with Electronic Faucet, P-Trap, Overflow and Soap & Towel Dispenser



### SPECIFICATIONS

<b>Fabrication</b>	20 gauge stainless steel
<b>Bowl</b>	9-3/4"W x 12-1/2"L x 6" Deep drawn bowl with stamped rim to prevent spillage
<b>Wall Mount Bracket</b>	Offset design for added strength
<b>Faucet</b>	Single Hole Wall Mount Electronic Sensor Faucet
<b>Drain</b>	1-1/2" Stainless steel drain
<b>Drain with Overflow</b>	Stainless steel with plastic overflow tube and inlet
<b>Plumbing</b>	1/2" IPS hot and cold water. 1-1/2" IPS drain outlet. Install at 36" working height. 1/2" faucet supply 12" from floor. 1-1/2" drain line 23-1/4" from floor.
<b>Lead Free</b>	Faucet included is certified to NSF/ANSI 61 and 372 and conforms with the lead content requirements for lead free plumbing as defined by the U.S. Safe Drinking Water Act. Hand sink is certified NSF-2.

### OPTIONAL ACCESSORIES

<b>23-157</b>	Overflow Assembly
<b>H-100</b>	Chrome Plated 1-1/2" IPS P-Trap
<b>H-101</b>	Deck Mount Soap Dispenser
<b>H-105</b>	Wall Mount Towel Dispenser
<b>H-108-2</b>	16"W x 15"D Stainless Steel Skirt, Factory Installed
<b>H-108-9</b>	12"W x 17"D Stainless Steel Skirt, Factory Installed
<b>H-110</b>	Side Support Brackets
<b>H-111</b>	16"W Soap & Towel Dispenser
<b>H-115</b>	12"W Soap & Towel Dispenser
<b>H-116</b>	Wall Mount Soap Dispenser
<b>FG-L2</b>	15"D Factory Installed Left Side Splash
<b>FG-R2</b>	15"D Factory Installed Right Side Splash
<b>FG-LR2</b>	15"D Factory Installed Left & Right Side Splashes
<b>SG-L2</b>	15"D Field Installed Left Side Splash
<b>SG-R2</b>	15"D Field Installed Right Side Splash
<b>SG-LR2</b>	15"D Field Installed Left & Right Side Splashes

⚠ Warning: This product can expose you to chemicals including lead and lead compounds which are known to the State of California to cause cancer and birth defects or other reproductive harm. For more information go to [www.P65Warnings.ca.gov](http://www.P65Warnings.ca.gov).





Model: \_\_\_\_\_ Item #: \_\_\_\_\_ Date: \_\_\_\_\_

Project: \_\_\_\_\_ Qty: \_\_\_\_\_ Approved By: \_\_\_\_\_

### Hand Sinks w/ Electronic Faucets

### Hand Sinks

#### HS-11

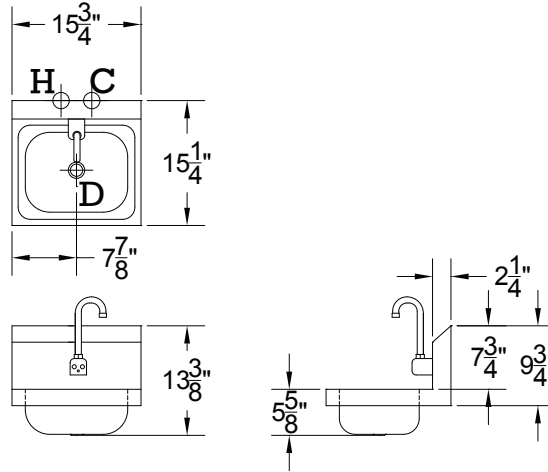

#### HS-12

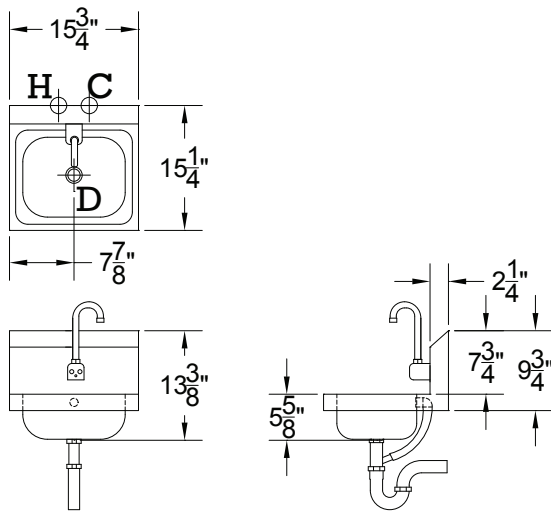

#### HS-13

